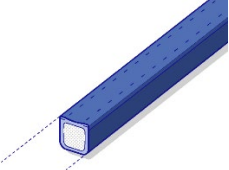
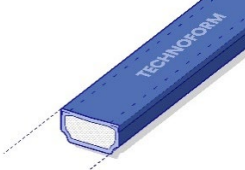
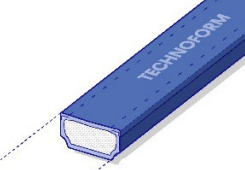
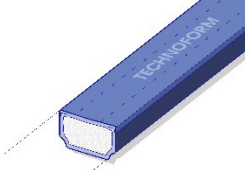

Master part chart

We are transitioning all our existing products and their brand names to article IDs.

Plastic hybrid stainless steel warm edge spacers

Former product brand names		New article ID
TGI-Spacer box		SP09/SP12
TGI-Spacer M without wire		SP13
TGI-Spacer M with wire		SP14
TGI-Spacer M with wire high profile		SP17

Plastic hybrid stainless steel warm edge spacers and accessories

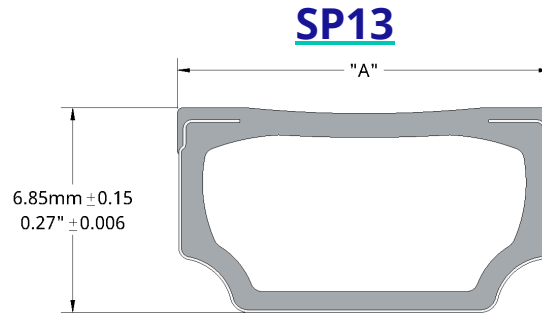

SP13 sizes and packaging

Size	Width "A" inches tolerance: ± 0.006 "	Width "A" millimeters tolerance: ± 0.15 mm	Spacer pieces/box	Box lengths & footage		
				13' (156") feet/box	16.42' (197") feet/box	19' (228") feet/box
13/32"	0.4004	10.17	204	2,652	3,349	3,876
7/16"	0.4315	10.96	170	2,210	2,791	3,230
15/32"	0.4669	11.86	153	1,989	2,512	2,907
1/2"	0.4941	12.55	153	1,989	2,512	2,907
17/32"	0.5291	13.44	153	1,989	2,512	2,907
9/16"	0.5567	14.14	136	1,768	2,233	2,584
19/32"	0.5937	15.08	136	1,768	2,233	2,584
16MM	0.6083	15.45	119	1,547	1,953	2,261
5/8"	0.6228	15.82	119	1,547	1,953	2,261
21/32"	0.6543	16.62	119	1,547	1,953	2,261
17/25"	0.6740	17.12	119	1,547	1,953	2,261
23/32"	0.7169	18.21	102	1,326	1,674	1,938
3/4"	0.7441	18.90	102	1,326	1,674	1,938
24MM	0.9232	23.45	85	1,105	1,396	1,615
1"	1.0020	25.45	85	1,105	1,396	1,615

SP14

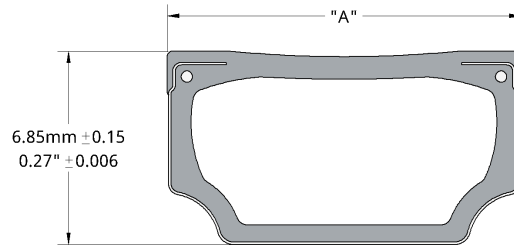

SP14 sizes and packaging

Size	Width "A"	Width "A"	Spacer pieces/box	Box lengths & footage		
	inches tolerance: $\pm 0.006''$	millimeters tolerance: $\pm 0.15\text{mm}$		13' (156") feet/box	16.42' (197") feet/box	19' (228") feet/box
13/32"	0.4004	10.17	204	2,652	3,349	3,876
7/16"	0.4315	10.96	170	2,210	2,791	3,230
15/32"	0.4669	11.86	153	1,989	2,512	2,907
1/2"	0.4941	12.55	153	1,989	2,512	2,907
17/32"	0.5291	13.44	153	1,989	2,512	2,907
9/16"	0.5567	14.14	136	1,768	2,233	2,584
19/32"	0.5937	15.08	136	1,768	2,233	2,584
5/8"	0.6228	15.82	119	1,547	1,953	2,261
21/32"	0.6543	16.62	119	1,547	1,953	2,261
17/25"	0.6740	17.12	119	1,547	1,953	2,261
23/32"	0.7169	18.21	102	1,326	1,674	1,938
3/4"	0.7441	18.90	102	1,326	1,674	1,938
24MM	0.9232	23.45	85	1,105	1,396	1,615
1"	1.0020	25.45	85	1,105	1,396	1,615

SP17

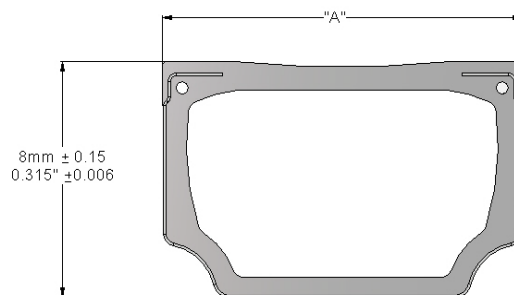

SP17 sizes and packaging

Size	Width "A"	Width "A"	Spacer pieces/box	Box lengths & footage		
	inches tolerance: $\pm 0.006''$	millimeters tolerance: $\pm 0.15\text{mm}$		13' (156") feet/box	16.42' (197") feet/box	19' (228") feet/box
1/2"	0.4941	12.55	144	1,872	2,364	2,736

SP09/SP12

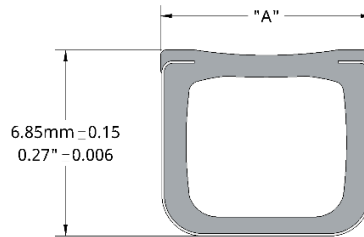

SP09 & SP12 sizes and packaging

Size	Width "A" inches tolerance: ±0.006"	Width "A" millimeters tolerance: ±0.15mm	Spacer pieces/box	Box lengths & footage		
				13' (156") feet/box	16.42' (197") feet/box	19' (228") feet/box
1/4" (SP09)	0.2441	6.20	323	4,199	5,303	6,137
5/16" (SP12)	0.3067	7.79	255	3,315	4,187	4,845
3/8" (SP12)	0.3693	9.38	204	2,652	3,349	3,876

Accessories

Pieces per box = 2,500

- = product available in the listed size
- NA = product is not available

SP13 & SP14 accessories

Size	Steel straight connector	90° fixed corner connector	Gas filling corner connector with hole	Gas filling corner connector w/o hole	Plug for gas filling connector
		CN34	CN38	CN39	CN40
13/32"	CN20	■	■ (CN62)	■ (CN63)	■
7/16"	CN20	■	■	■	■
1/2"	CN60	■	■	■	■
15/32"	CN60	■	■	■	■
17/32"	CN60	■	■	■	■
9/16"	CN60	■	■	■	■
19/32"	CN60	■	■	■	■
16MM	Same as 5/8"	NA	■	■	■
5/8"	CN60	■	■	■	■
21/32"	CN60	■	■	■	■
17/25"	CN20	■	■	■	■
23/32"	CN20	■	■	■	■
3/4"	CN60	■	■	■	■
24MM	CN23	■	NA	NA	NA
1"	CN60	■	NA	NA	NA

SP17 accessories

Steel straight
connector

Size	CN25
1/2"	■

SP09 accessories

	Steel straight Connector	90° fixed corner connector	Gas filling corner connector with hole	Gas filling corner connector w/o hole	Plug for gas filling connector
Size	CN16	CN35	CN36	CN37	CN40
1/4"	■	■	■	■	■
5/16"	■	■	■	■	■
3/8"	■	■	■	■	■

Colors for spacers, gas filling connectors, and plugs

Black - BK

Bronze - BR

Dark gray - DG

Light gray - LG

White - WH



Custom colors available. Please contact us for additional information.

Please include with your order: Article ID + size + color + length

**In case of specific questions or availability in your market, please contact us.
We gladly offer our individual support.**

Thermal edge bond solutions for insulating glass